

FORM

PIONEERING DESIGN

THE FUTURE

FOLLOW THE SUN

Making the Most of Nature

URBAN APPEAL

Older Cities Look to the Past

ON THE BOARDS

A Look at What's Coming

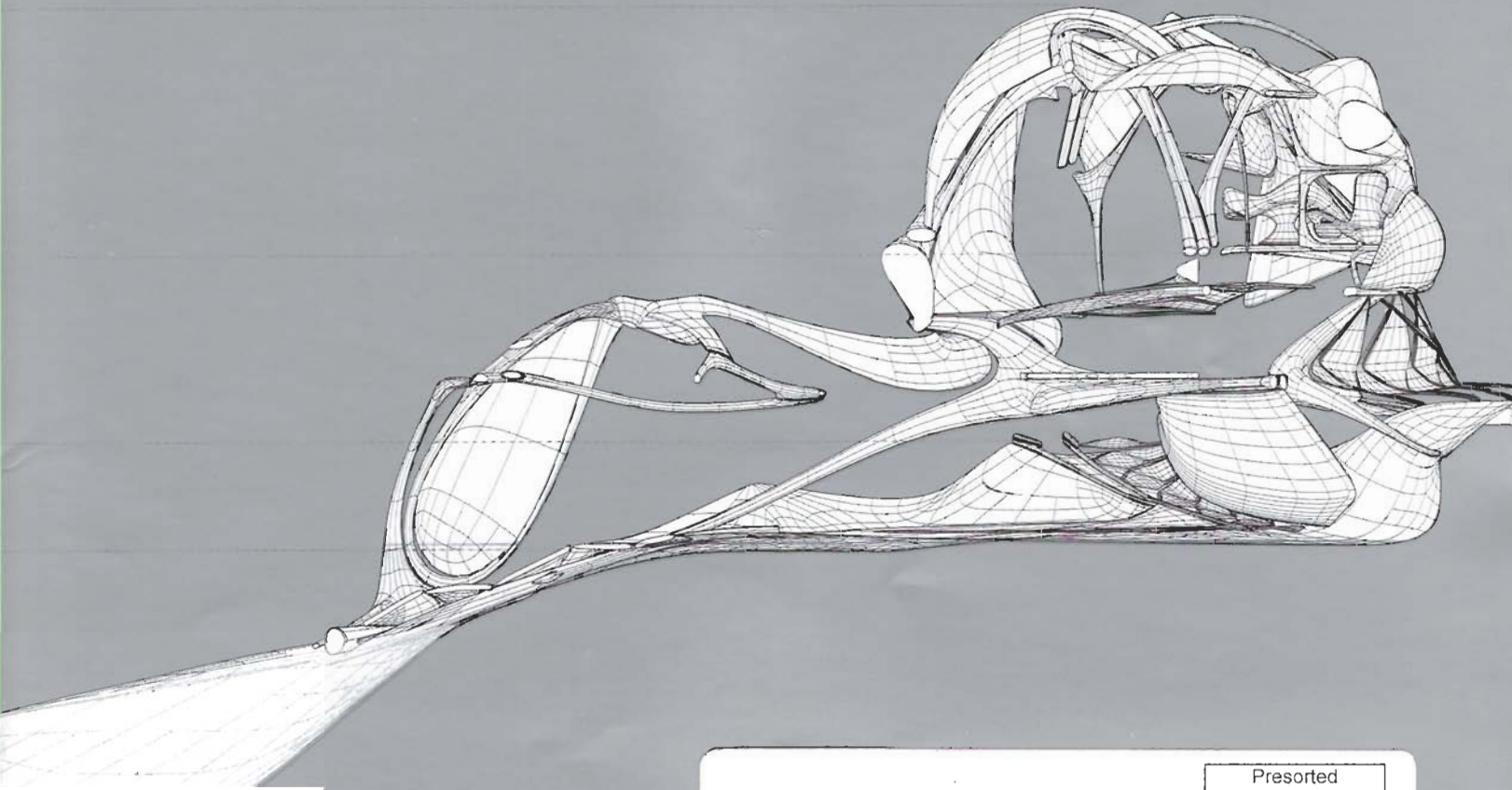

U.S. \$6.95 / CANADA \$8.95



13

86345 97698 1

MAY/JUNE 2008

PUBLICATION OF BALCONY MEDIA, INC.

Presorted
STANDARD
U.S. Postage
PAID
Bell, CA
Permit #75

*****ECRLOT**C-023

Marcello Pozzi

2500 Broadway Ste 300
Santa Monica CA 90404-3099





Farina Casseforme Pavilion

Location: Convention Center, Las Vegas

Designer: MLL0 Design

Web site: www.mllo.net

The design of the Farina Casseforme pavilion at the World of Concrete trade show in Las Vegas earlier this year was an effort to transform fragments of temporary construction—the steel formworks panels—into built architecture. The formwork system becomes architecture through metaphorical translation of the steel fragments into architectural language; thus the decision of designing the entire pavilion with the formwork system.

The pavilion design was inspired by the contemporary architecture and design experimentation typical of the West Coast. Its heavy panels were to evoke a sensation of dynamic lightness, and so 400-pound panels, originally produced to hold and form tons of fluid concrete up to a pressure of 80kN/m², appear buoyant as they float and fold in a surreal setting. With the applied graphics, they are reminiscent of the billboards along the streets of Los Angeles. However, these “billboards” with their controversial and ironic slogan form a deconstructed cluster suspended in the air.

The modular system of exposed structural galvanized steel, clamps, tie rods, and the phenolic resin-finished plywood are used out of context and become a new architectural language. The installation is composed of seven different folded and fragmented portals of panels staggered to create a dynamic composition. The pavilion had a 30-foot by 20-foot area with a maximum height of 21 feet.

The greatest challenge to the design was calculating an appropriate structure to support the heavy panels without a continuous anchoring platform. A related issue was how to determine an assembly sequence which took into consideration the height of the pavilion and the stability of the structure during the installation. The resolution came by implementing a series of steel “angled arches” which support the panels. Each arch has a double channel section welded to follow the configuration of the portals. The panels are fixed on the arches with universal fixing bolts. The portals are braced to each other by the connection of adjacent panels by quick acting clamps.

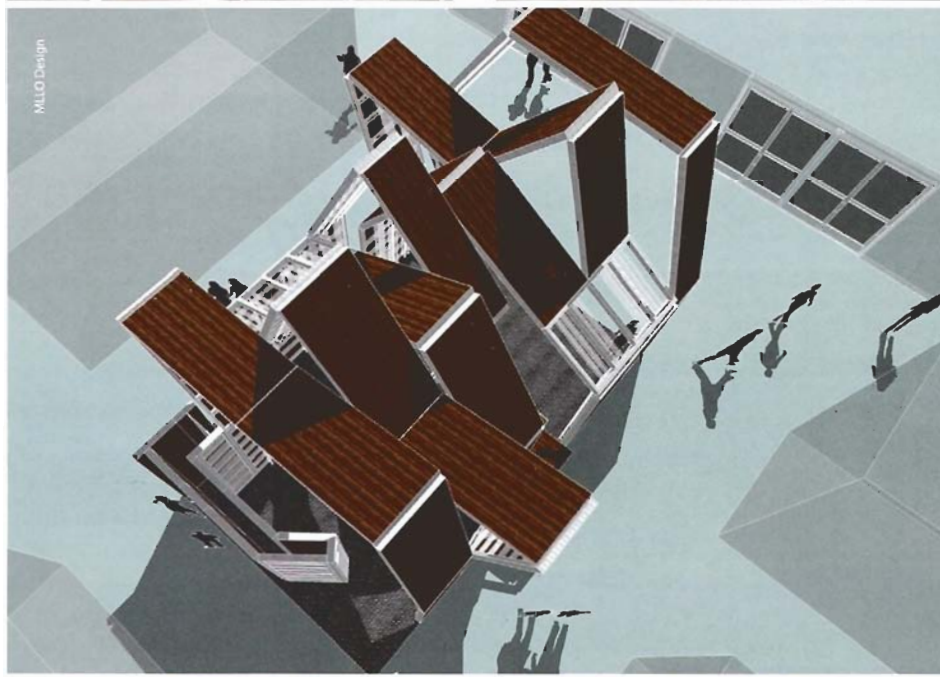

CREDITS

Maison Seroussi

LOCATION: Paris

DESIGN TEAM: Hernan Diaz Alonso, Principal; Joshua

Taron, Project Architect

PROJECT TEAM: Brian De Luna, Job Captain; Marcus

Friesl, Robert Cha, Sanjay Sukie, Josh Sprinkling

ANIMATION: Erick Carcamo

Villa_OR

LOCATION: Lemont, Illinois

DESIGN TEAM: Paul Preissner, Principal-in-Charge,
Katherine Monachos

STRUCTURAL ENGINEER: Skidmore Owings
and Merrill LLP (Chicago)

GEOTECHNICAL ENGINEER: Cemcon Inc.

100K House

LOCATION: Philadelphia

DESIGN TEAM: Brian Phillips, Principal;
May Narisaranukul, Associate

PROJECT TEAM: Justin Diles, David Williams

MEP ENGINEER: Ross Mechanical Group Inc.,
Ross Goldstein

LEED CONSULTANT: MaGrann Energy/Building
Consultants & Engineers, Sam Klein, Rob Wisniewski

CONTRACTOR: Level 5 Construction, Scott Yohe, Owner
and Project Manager

26th Street Apartments

LOCATION: Austin, Texas

DESIGN TEAM: Kevin Alter

COLLABORATING ARCHITECT: Sinclair Black & Andrew
Vernooy Architects, Andrew Vernooy

St. Thomas the Apostle School

LOCATION: Los Angeles

DESIGN PRINCIPALS: John Enright, Margaret Griffin

PROJECT ARCHITECT: Mathew Gillis

PROJECT TEAM: Dorian Bybee, Clark Thenhaus, Jenny
Tse, Kyle Miller, Taka Mieno, Ray Shapiro, Andrew
Kao, Holly Chisholm

CIVIL ENGINEERS: KPFF Consulting Engineers

STRUCTURAL ENGINEERS: GILSANZ, MURRAY, STEFICEK,
INC and Seneca Structural Engineering

MECHANICAL / ELECTRICAL / PLUMBING ENGINEERS:

Antieri & Haloosim Consulting Engineers

CONTRACTOR: Del Amo Construction, Inc.

Farina Casseforme Pavilion

LOCATION: Las Vegas

DESIGN TEAM: Marcello Pozzi

FABRICATION AND ENGINEERING: Farina Casseforme,
Ottavio Farina, Ivan Vertemati, Massimo Bassi

GRAPHIC DESIGNER: Emanuele Gipponi

PHOTOGRAPHY: Massimiliano Farina



SHARPE

INTERIOR SYSTEMS

DRYWALL CONTRACTORS